

MERCURY (QHDSS)

QHDSS cable cleats are metallic cable cleats that have been designed, constructed, and tested in accordance with the International Standard IEC 61914 'Cable Cleats for Electrical Installations' to ensure the securing and retention of cables, without sustaining damage to the cable.

The range is fabricated from 316L stainless steel, giving it high creep strength whilst providing excellent corrosion resistance in the harshest of environments. Designed for quad application / formation. The QHDSS cleat is ideal for use in data centres, rail and other industries and applications where the neutral and three-phase conductors are secured together.

The cleat has three M10 clearance holes within its base allowing versatility to the installer during installation, and is designed to enable the product to be secured to a variety of mounting surfaces. The pre-formed and hinged cleat opens fully, allowing the cables to be easily placed within the cable cleat to aid the installer before closing and securing via the mouth bolt.

Liners come as standard which help to restrain the cables within vertical applications. Where thermal elongation of cables occurs, the liner also provides a layer of protection between the cable sheath and the cable cleat during normal operation. This additional layer protects the cable from chafing on any mounting surface due to differential movements such as those found in marine and offshore applications. The liners assist in the protection of cable(s) in the event of short circuit fault conditions. The standard polymeric liners supplied are classified as Low Smoke & Fume (LSF), Zero Halogen (LSOH) and Phosphorus Free.



TECHNICAL DATA & CLASSIFICATION

TYPE	IEC 61914 6.1.3 Composite QHDSS - Quad Heavy Duty Stainless Steel
DESIGN SPECIFICATION	IEC 61914
TEMPERATURE FOR PERMANENT APPLICATION	-60°C to +60°C
NEEDLE FLAME TEST	Pass - 120 second flame application time IEC 61914 clause 10.0, 10.1, IEC 60695-11-5
LATERAL LOAD TEST	Refer to CMP Products
AXIAL LOAD TEST	Refer to CMP Products
IMPACT RESISTANCE	Pass - Very heavy
MATERIAL	316L stainless steel with standard liners

SHORT CIRCUIT TESTING TO IEC 61914 CLAUSE 9.5

One short circuit 300mm fixed cleat centres	One short circuit 300mm fixed cleat centres	One short circuit 600mm fixed cleat centres	One short circuit w/ Cyclone III strap 600mm fixed cleat centres
0.1 sec	1 sec	0.1 sec	0.1 sec
189kA Peak	98.2kA Peak	139kA Peak	171kA Peak
85.9kA r.m.s	44.6kA r.m.s	63.2kA r.m.s	77.7kA r.m.s

FEATURES

- 316L stainless steel
- For quad formation / application
- Short circuit rating of 154kA peak fault
- Operating temperature -60°C to +60°C or -76°F to +140°F
- Combined single (M10) or 2 bolt (M10) fixing design

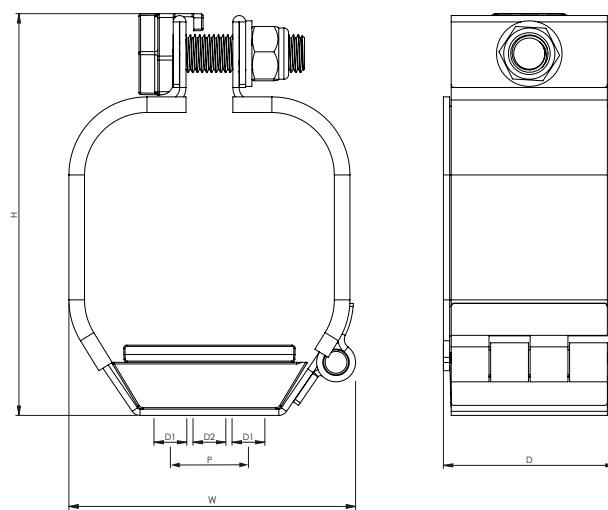

CABLE CLEAT SELECTION TABLE

QUAD PART NO.	CABLE Ø RANGE	DIMENSIONS (mm)						WEIGHT (g)
		W	H	D	P	FIXING HOLE Ø		
						D1	D2	
QHDSS016020	16-20	66	89	58	N/A	N/A	1 x M10	430
QHDSS019023	19-23	69	95	58	N/A	N/A	1 x M10	440
QHDSS021027	21-27	76	103	58	N/A	N/A	1 x M10	513
QHDSS026031	26-31	80	111	58	N/A	N/A	1 x M10	516
QHDSS030034	30-34	83	117	58	N/A	N/A	1 x M10	524
QHDSS031035	31-35	84	119	55	25	2 x M10	1 x M10	535
QHDSS033037	33-37	87	122	55	25	2 x M10	1 x M10	537
QHDSS036040	36-40	93	129	55	25	2 x M10	1 x M10	546
QHDSS039043	39-43	99	135	55	25	2 x M10	1 x M10	553
QHDSS041045	41-45	103	139	55	25	2 x M10	1 x M10	575
QHDSS044047	44-47	107	142	55	25	2 x M10	1 x M10	562
QHDSS046051	46-51	113	149	55	50	2 x M10	1 x M10	643
QHDSS049053	49-53	119	155	55	50	2 x M10	1 x M10	649
QHDSS052056	52-56	125	161	55	50	2 x M10	1 x M10	664
QHDSS055059	55-59	131	167	55	50	2 x M10	1 x M10	667
QHDSS058062	58-62	137	173	55	50	2 x M10	1 x M10	686
QHDSS061065	61-65	143	179	55	50	2 x M10	1 x M10	703
QHDSS064068	64-68	149	185	55	75	2 x M10	1 x M10	812
QHDSS067071	67-71	155	191	55	75	2 x M10	1 x M10	830

Additional sizes are available upon request.

Coatings are available upon request by adding the following suffixes to the ordering reference – EC for epoxy coating, PC for polyester coating and TC for thermoplastic coating. Example order reference for epoxy coating suffix EC (QHDSS026031EC). Fasteners required to secure the cable cleat to the support structure are not included but can be supplied upon request - see cleat fixing pack page. Isolation/separation pads (to prevent corrosion between two dissimilar metals) are not included but can be supplied on request - see isolation/separation pad page.